

## FROM THE ARCHIVES

### William Edward Gleason 1839-1906

William Gleason was born in County Clare, Ireland on 1839. William was the son of Michael and Honoria O'Brien Gleason. William immigrated to the United States with his parents in 1844.

He married Ann Melahan in 1864 and they had eight children. William can be found in California voter registration in 1867 in Bodega Township in Sonoma County. It is believed that William settled on what became known as Gleason Dairy Ranch in either the late 1850's or early 1860's. His wife, Ann passed away in 1882.

William married Bridget McGee in January 1884. William and Bridget had seven children. William, Bridget and some of their children moved to the old 615 acres Platt Ranch outside Bodega Corners, in the early 1890's.

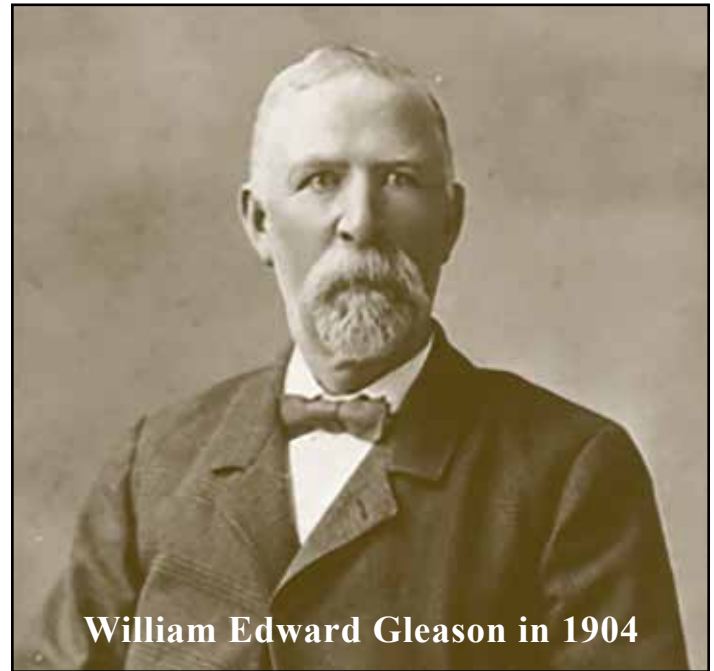

William Edward Gleason in 1904

### Gleason Dairy Ranch



Gleason Dairy Ranch was located at 6000 Highway One, north of Sereno del Mar along the Sonoma Coast and was registered as a Sonoma County Historic Landmark, #119, in 1982. The ranch is now owned by Philip and Roberta Ballard. The ocean side of Highway One was named Gleason Beach, after William Edward Gleason, who owned the coastal 175 acres in the late 1800s. William passed in 1906.



Gleason Beach

By 1910, William's son, David Gleason moved the Dairy Ranch inland near Bodega Corners, (across the road from the Watson School). Later it was operated by Tony & Barbara (Gleason) Prebilich and great great grand daughters Nancy Prebilich and Cindy Holland. Sadly in 2013, forced by economic hardship, the ranch was sold. (onherownfilm.com) ■

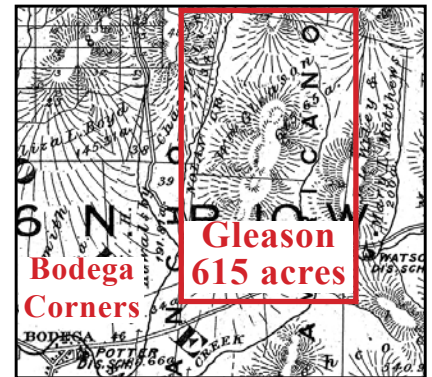

Gleason Bodega Corners 615 acres

**1884 William &  
Bridget Gleason  
wedding**

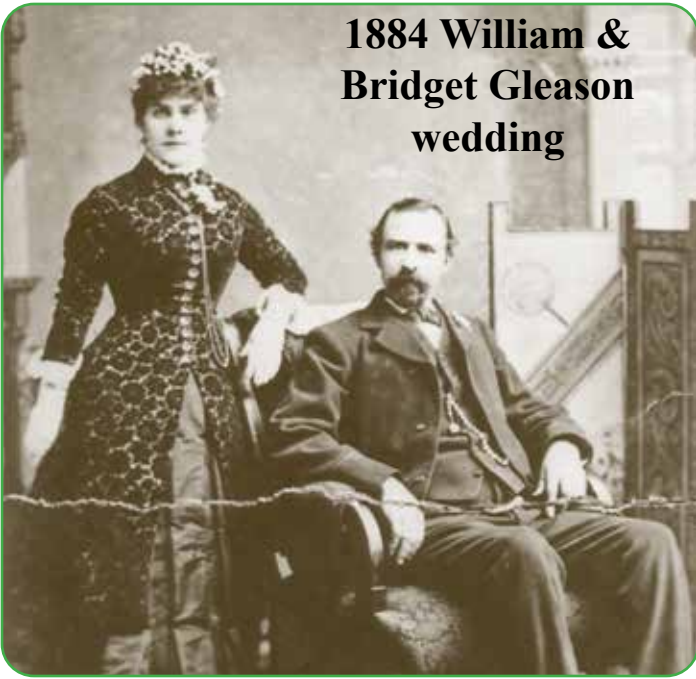

**Charlie, Ed, William,  
Mae, Bridget, Walter,  
Leo & Frank Gleason  
1897**

**1896 Gleason Family  
at Scotty Creek Ranch**

